

## 2. Change the previously set walls:

a.) Cut surfaces:

- Cut Lines: Solid Line
- Cut Line Pen: 8 (red)

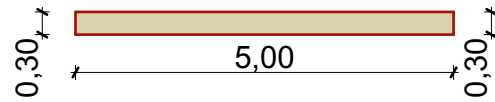

b.) Outlines:

- Wall End Lines: None

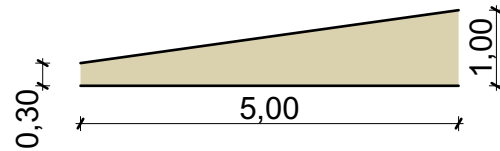

c.) Building Material:

- Masonry - Brick Aged
- Cut Surfaces:
  - Cut Lines: Dashed
  - Cut Line Pen: 27 (black)

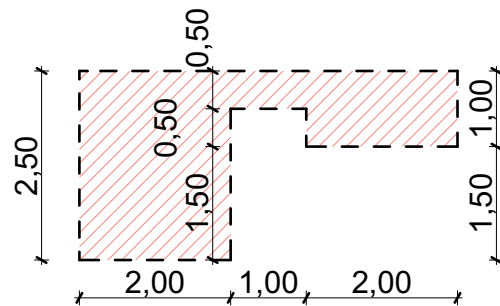

## 3. Wall tool (Wall Top: None Linked - 12,00 m Wall Height):

a.) Structure:

Composite:

- Double 50 Block Cavity Plastered

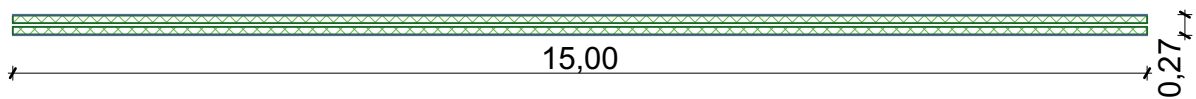

b.) Structure:

Complex Profile:

- Brick Veneer Block Wall

